

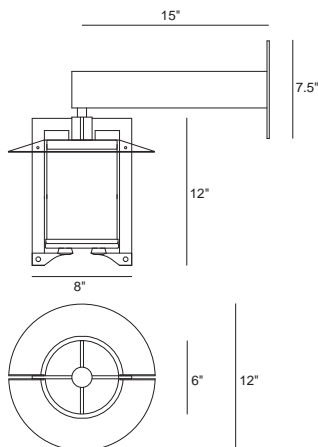

HID integral canopy option shown, LED version is supplied as standard integral, with the driver mounted in the arm.



Orchestra Circle 2757WLED Mini Wall Arm Mount INTERIOR

MODEL	LED		VOLT	SHIELD	DIFFUSER	OPTIONS	COLOR
	WATTS	COLOR TEMPERATURE					
2757W	20L	40	120*	PF <i>perforated liner</i>	RF* <i>frost</i> CL <i>clear</i>	WL <i>wet location listing</i>	WT <i>white texture</i>
	1313 lumens ¹	4000K	208			DIM <i>dimming driver</i>	BT <i>black texture</i>
	20w LED/23w system	30	240			90 <i>90 CRI</i>	SM <i>silver metallic</i>
		3000K	277				AN <i>aluminum natural</i>
		35	347+				BZ <i>bronze</i>
		3500K					GM <i>gunmetal</i>
							WS <i>white satin</i>
							BM <i>black matte</i>
							RAL <i>specify no.</i>

*Standard configuration unless otherwise specified ¹Delivered lumens based on PF option and standard frost diffuser (4000K, 80CRI) +Consult factory

SAMPLE CATALOG NUMBER: 2757W - 20L40 - 120 - RF - WT

Using this catalog number would order 1 model 2757WLED mini circle wall arm mount luminaire with LED light engine, 4000K, 80 CRI wired to 120 volts with frosted acrylic lens and painted with white texture polyester powder coat.

CONSTRUCTION	MOUNTING	OPTICAL	PROTECTION
<p>Materials Support Frame: Aluminum plate. Arm assembly: Rectangular extruded aluminum. Hinge/Lock up: Pressure die cast aluminum. Wall canopy / Reflector disk: Aluminum. Diffusers (side): Thermo-formed acrylic. Bottom lens: Acrylic. Fasteners: Stainless steel.</p> <p>Electrical Components Drivers: Constant current. 550 mA, 84% efficiency, integral mount standard. Light engine: COB 1205 24mm x 20mm with a 13mm LES.</p>	<p>Luminaire is designed for mounting over a recessed 4" octagon j-box (by others). Holes (4) are provided in wall plate to attach to the wall outside of the j-box. Adequate backing is required inside the wall to support these fixtures. Arm assembly is shipped separately from the head for field attachment.</p>	<p>Luminaire has a choice of frost or clear lens and diffuser, with frost supplied as standard. The perforated liner is supplied if specified. The reflector disk is set to the top position. Standard optic is type V square (130°).</p>	<p>The Orchestra mini wall mount is listed for use in damp locations to UL and CSA Standards. An optional wet location label can be provided (LOC 4, wall surface).</p> <p>LEDs are rated for 50,000 hour life with lumen maintenance >70% (L70).</p>

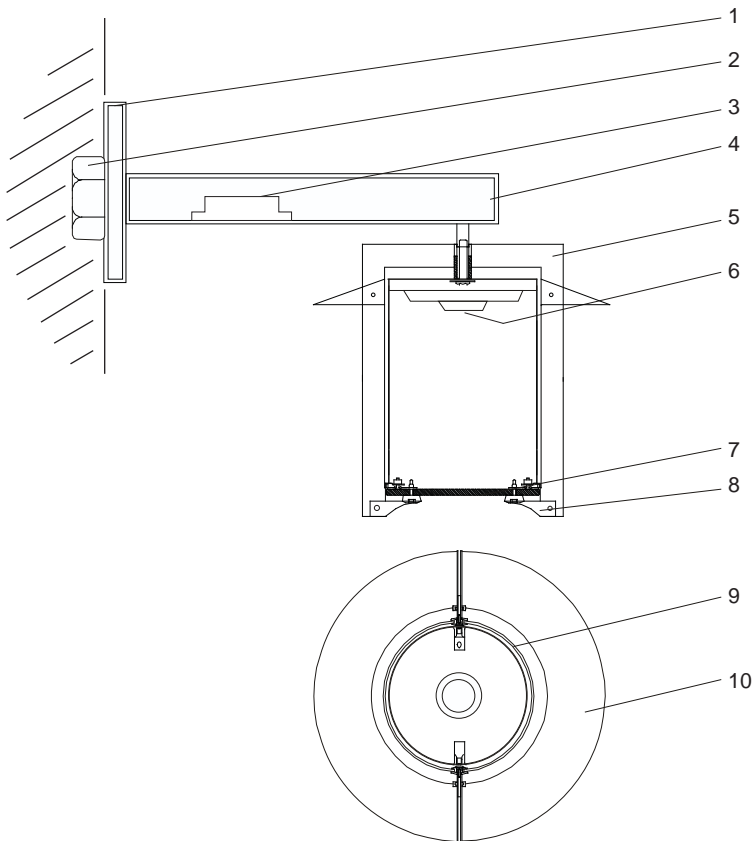

Orchestra Circle 2757WLED Detailed Product Description

- | | | | |
|---|---|----|--|
| 1 | Wall Plate .188" Aluminum | 7 | Acrylic Lens .375" Thick |
| 2 | 4" Recessed Octagon J-Box (By Others) | 8 | Diecast Aluminum Lock Up |
| 3 | Driver | 9 | Acrylic Cylinder (.125" Thick) |
| 4 | Mounting Arm Bracket 1.5" x 3.00" x .100" Wall Aluminum | 10 | Reflector Disk .081" Aluminum (Fixed - Top Position) |
| 5 | Frame Support .250" Aluminum | | |
| 6 | Downlight LED Light Engine with Silicone Optic and Heatsink | | |